

Product information

Metra-view totaliser & ratemeter data sheet

- Self powered
- Long battery life (up to 10 years)
- -20 to 80 °C (-4 to 176°F Operation)
- Simple programming with English prompts
- IP67 (Nema 4X)
- Scaleable pulse output (PNP or NPN)10 point linearisation
- Non volatile memory
- 5 Digit rate indication
- 8 Digit total & accumulated total
- Low battery indicator
- Clear 9mm (0.35") "starburst" LCD display
- Remote/local reset
- 10 point linearisation

Ideal for

- ◆ Flow rate & total
- ◆ Production lines
- ◆ Fuel consumption
- ◆ Process indicators



The metra-view was specifically designed for computing & displaying rates and totals from flowmeters or machinery with pulse or frequency outputs. The instrument will display Re-settable Total, Accumulated Total and flow rate in engineering units as programmed by the user. Simple PIN protected flow chart programming with English prompts guide you through the entire programming routine greatly reducing the need to refer to the instruction manual. The optional pulse output can be selected to act as an input pulse repeater serving as a signal conditioner module or may be programmed as a scaled pulse output for remote metering. There is a ten point linearisation for non-linear sensors. The pulse output requires an external 8 - 24Vdc power supply, the pulse width is auto-ranging 1:1 defaulting to 300ms maximum. The robust housing is purposely designed to suit harsh indoor & outdoor industrial and marine environments. It is weatherproof to P67 (Nema 4X) standards, UV resistant and uses glass reinforced nylon mouldings with stainless steel screws & viton O-ring seals.

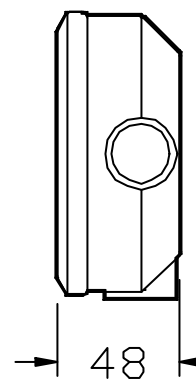
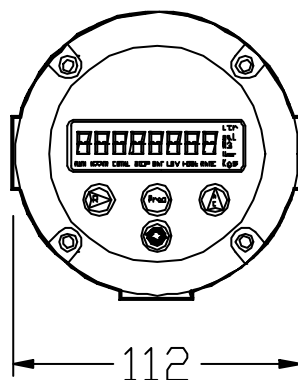

Order code

Metra-view
380-100

Wall bracket
380-103

The drawing below shows all of the segments on the LCD display illuminated. This occurs for five seconds whenever the program mode is entered.

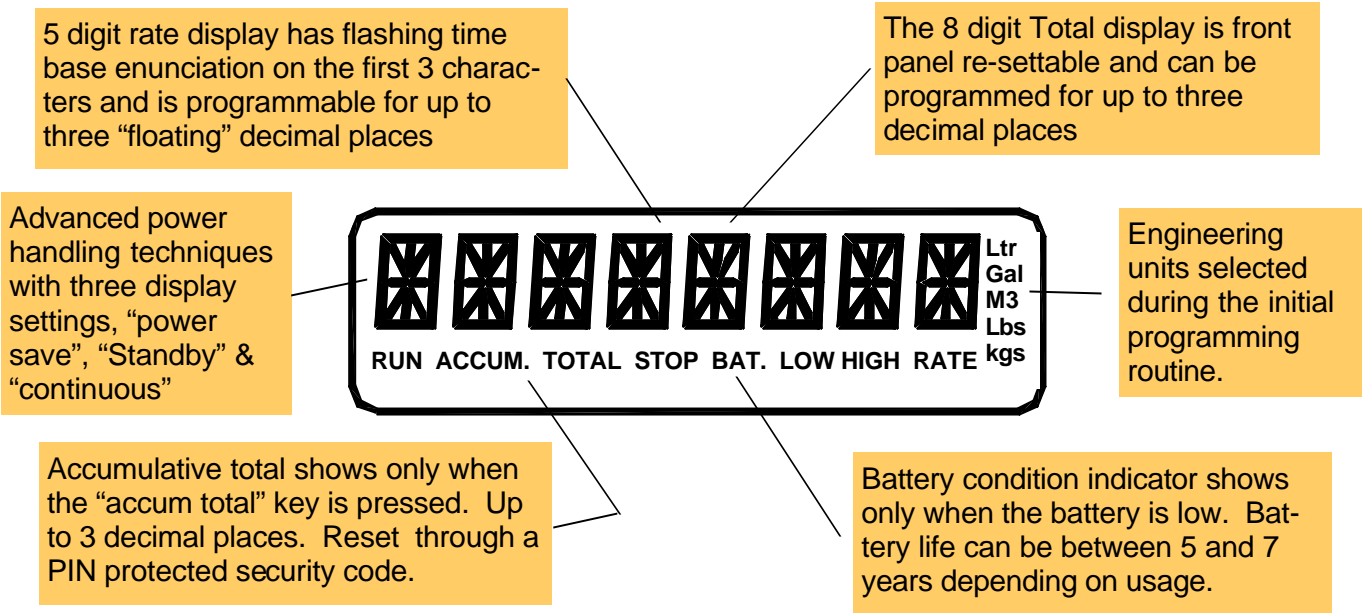

Specification

Display	LCD 8 digit alpha-numeric 9mm high Engineering units & mode indicators Low battery indicator 3 programmable decimal points for both totalisers English programming prompts
Signal inputs	Universal pulse-frequency input compatible with reed switch, Hall effect detector, magnetic coil (20mV P-P), Voltage pulse & Namur proximity detectors. Maximum input frequency 500 to 5Khz depending on sensor type, minimum 2Hz, (0.2Hz when used on external power).
Power	Internal 3.6V dc Ultra lithium battery. Life expectancy 5 - 7 years (less with the coil input). An external power supply (8-24Vdc regulated) may also be used .
Pulse output	Scalable selectable NPN or PNP it has a maximum frequency of 100 Hz. @ 1A maximum
Enclosure	IP66 (NEMA 4X) High impact glass reinforced nylon. Self drill cable gland in the base or rear. Operating temperature range -20°C to +80°C.
K Factor range	0.001 to 9,999,999.999
Rate time base	Seconds, minutes, hour or day

Programming flow chart

Display	Action
Program mode entered	Display self tests
Enter PIN number	XXXX
Change PIN number Y/N	Incorrect PIN number permits viewing of the program data only
Reset ACCUM total Y/N	
Set engineering units	Ltr, gal, M3, lbs, kgs or none
Enter pulses per unit volume	E.g. 20.465 Pulses per litre etc.
Set decimal point	Dpt TOTAL 0 0.0 0.00 0.000 Dpt ACCUM TOTAL 0 0.0 0.00 0.000 Dpt RATE 0 0.0 0.00 0.000
Rate conversion Y/N	Converts from one unit to another e.g. Litres to M3
Set time base for rate	SEC MIN HR DAY
Set rate dampening	Damp rate 00-99
Output pulse required Y/N	If yes
Enter volume per pulse	XXXX.X
Non linear correction Y/N if yes enter ten frequency and pulses per unit volume for each flow rate	If yes over rides pulses per unit volume already set. 0000.0 output freq. 000000.00 'K' factor
Change power mode Y/N	ULTRA POWER SAVE STANDBY CONTINUOUS